



Stirling Homes Queensland THE DALLAS

The Dallas design is a three bedroom plus study home designed around the country cottage feel.

As you enter this home you are greeted by a large lounge/family room, great for entertaining family and friends.

The kitchen comprises of a 'U' shape design with a large corner pantry and a breakfast bar which joins onto the dining area.

The rear verandah is accessible from both the dining area and master bedroom making it easier for you to enjoy your surroundings.

This home has great storage with all bedrooms having built in robes, along with a linen cupboard in the laundry. This home would perfectly suit a small family, couple or individuals with a smaller budget who still want all of the features of a larger home.

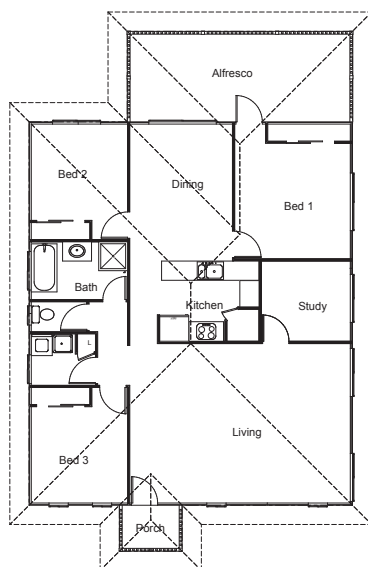

FLOOR PLAN

| | |
|---------------------|---------------------|
| LIVING AREA: | 120.2m ² |
| ALFRESCO | 20m ² |
| PORCH: | 2.8m ² |
| TOTAL: | 143m ² |

