

*stylish & affordable*

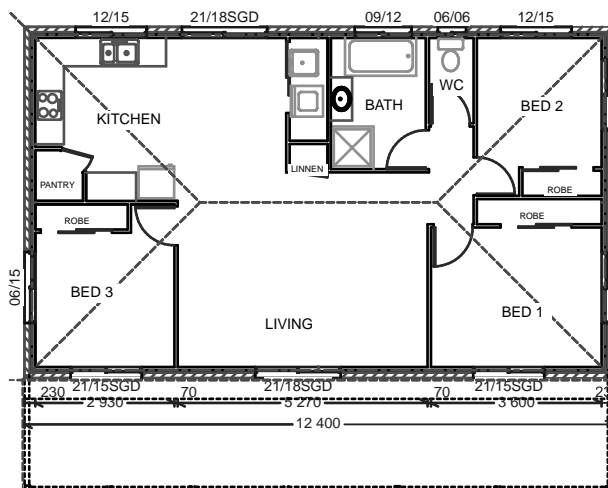

## Stirling Homes Queensland THE RANCH

This three bedroom home is a delight for first home owners or a growing family. There are clever storage spaces in this design with the laundry tucked away neatly in a cupboard, undetectable linen and built in robes in every bedroom. The whole family can spend time relaxing together in the large, open plan living and dining areas. This is a modern and highly sought after feature in today's market. A large verandah runs along the front of the home, giving plenty of room to entertain friends and family. The Ranch is a design you would be happy to come home to.



### FLOOR PLAN

LIVING AREA:	91.7m <sup>2</sup>
OUTDOOR AREA:	29.7m <sup>2</sup>
TOTAL:	121.4m <sup>2</sup>



# Cottage Collection