

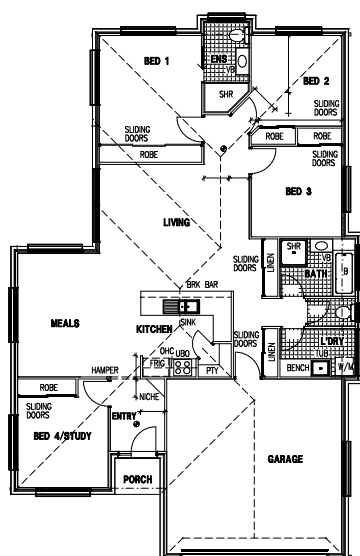

Stirling Homes Queensland **THE MAINE**

This beautiful design is sophisticated & elegant with amazing street appeal. The Maine is a four bedroom design with ensuite and separate living. The design includes an internal laundry with ample space & storage. The centre kitchen provides separate living & dining areas which are a modern feature for today's families. This home is a fantastic new design at an affordable price it suits families & investors alike.



| FLOOR PLAN | |
|---------------------|----------------------|
| LIVING AREA: | 167.98m ² |
| ENTRANCE: | 1.8m ² |
| PATIO: | 13.86m ² |
| TOTAL: | 183.64m ² |

