

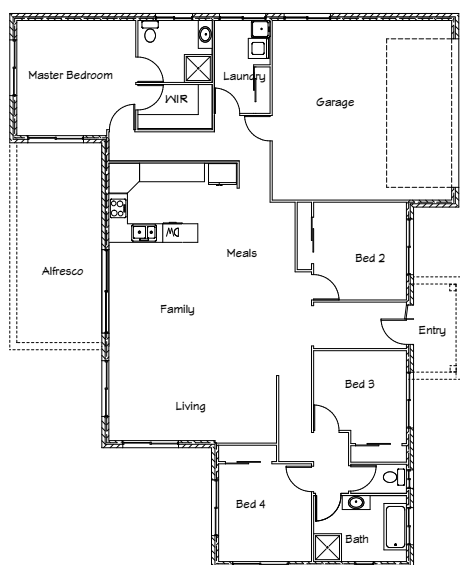

Stirling Homes Queensland THE TEXAS

The Texas lives up to its name, with a ranch style front façade. This home is truly a delight, with the Master bedroom secluded to the back of the house, giving a perfect parents retreat. The children's bedrooms are spaced apart to the front of the house, giving each their own personal space. With open plan living and lovely large kitchen, there is something for everyone. The Texas is the perfect family home.



FLOOR PLAN

LIVING AREA:	151m ²
GARAGE:	37m ²
PATIO:	20m ²
PORCH:	5m ²
TOTAL:	213m ²

